

# INDUSTRIAL BLANKET



It is a stone wool blanket that is used for thermal insulation and fire safety of industrial plants, process equipments, large diameter pipes.

## Application

Noncombustibility of Stone Wool Industrial Blankets enables them to be used for thermal, sound and fire insulation of very high temperatures. The blankets are cut to size and wrapped around the surface to be insulated. The joints are laced with galvanized wire by passing it through the eyes of the wiremesh. Care should be taken to ensure that the joints fit properly and no gap is left at the joints. During the application on large surfaces, the blankets should be impaled over welded pins of 5-6 in number per square meter. The blankets are held in position by placing retaining washers over the pins. These pins also work as spacers for the insulation between the sheet metal cover and the insulated surface.

There are three different types of industrial blankets available as 650, 700 and 750 with different technical properties.

650 - 700	Thickness (cm)	Width x Length (cm)	Package (m <sup>2</sup> )
	3	100 x 800	8
	4	100 x 800	8
	5	100 x 500	5
	6	100 x 500	5
	8	100 x 300	3
	10	100 x 300	3
	12	100 x 300	3

750	Thickness (cm)	Width x Length (cm)	Package (m <sup>2</sup> )
	3	100 x 800	8
	4	100 x 600	6
	5	100 x 500	5
	6	100 x 400	4
	8	100 x 300	3
	10	100 x 300	3

Type		650	700	750
Density (kg/m <sup>3</sup> )		80	100	125
Declared Thermal Conductivity (W/mk)	Average Temperature (°C) 50	0,048	0,048	0,047
	100	0,063	0,058	0,057
	150	0,073	0,068	0,067
	200	0,083	0,078	0,077
	250	0,093	0,089	0,087
	300	-	-	-
	350	-	-	-



- High thermal insulation
- Fire safety
- Sound insulation
- Easy to apply



# TECHNICAL DATA SHEET

## izocam Industrial Blanket

Properties	Symbol	Unit	Description								Tolerance	Standard
Material Type			650	700	750						-	-
Material	-	-	Stone Wool								-	TS EN 14303
Density	$\rho$	kg/m <sup>3</sup>	80	100	125						+/-10%	-
Width	b	mm	1000								+/-10	TS EN 822
Length	l	mm	8000	5000	3000						-0, + $\infty$	TS EN 822
Thickness	d	mm	30	40	50	60	80	100	120 *	T2 **	TS EN 823	
Facing	-	-	Stitched with Galvanized Wire								-	-
Reaction to fire	-	-	A1								-	TS EN 13501-1
Declared Thermal Conductivity	T	°C	50	100	150	200	250	300	350	-	TS EN 12667/12939 13787	
	Type 650	$\lambda_D$	W/m.K	0,048	0,063	0,073	0,083	0,093	-			-
	Type 700			0,048	0,058	0,068	0,078	0,089	-			-
	Type 750			0,047	0,057	0,067	0,077	0,087	-			-
Max. Service Temperature	-	°C	-								-	TS EN 14706
Water Vapor Diffusion Resistance Coefficient ***	$\mu$	-	1								-	TS EN 12086
Packaging Material	-	-	PE Film								-	-

• Type 750 blankets can be manufactured up to 10 cm thickness.

\*\* T2: -5% or +5 mm; +15% or +15 mm. The biggest value is chosen at minus tolerance, the smallest value is chosen at plus tolerance.

### Safety Reminders for Loading, Unloading, Shipping and Storing

- These operations should be done indoors in case of rainy weather conditions.
- Loading and unloading should be done by (at least) two people.
- Products should be put on top of each other with extra care.
- Only backshutter of the truck body should be opened during unloading.
- Unloading should be carried out from backside to the front.
- Products should be wrapped by a waterproof cover even if the shipping distance is short.
- Products should be in packages (10 each) and maximum 6 packages can be superposed.
- Products should not be put into upright position during shipping and storing.
- Storing should be carried out by using pallets. But they should not superposed with pallets.
- Products should not be pulled by their package.
- Products should not be stepped on and should not be used as steps.
- The packages should be put on the floor with extra care so the corners of the product especially is not damaged by a hit.

Izocam is not responsible for any problem because of misprinting. Izocam, the manufacturer, reserves the right to alter product specifications without prior notice. Izocam also manufactures special products upon request. For your requirements, you are requested to contact our Export Department.

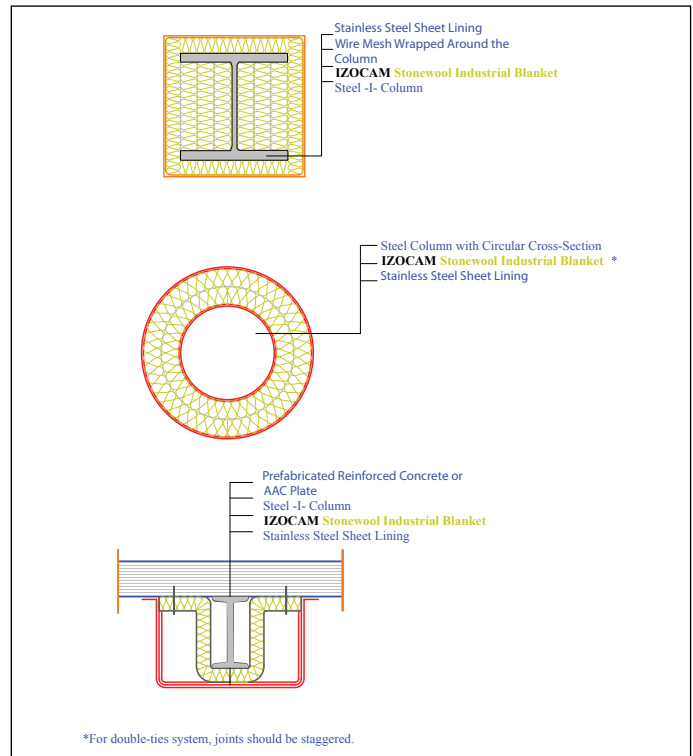

ENTYSS2015/06