

# FLAT ROOF BOARD



Flat Roof Board is an unfaced stone wool board, that is utilized for the thermal insulation, sound insulation and fire safety of all kinds of flat roofs.

## Application

İzocam Stone Wool Flat Roof Boards are used for thermal insulation, sound insulation and fire safety purposes under waterproofing. One layer of nylon cover is laid on corrugated metal roofing sheet as a vapour barrier. It is overlapped at the seams by 10 cm. and adhered to the surface. According to thermal insulation thickness, one or two layers of İzocam Stone Wool Flat Roof Board are laid on vapour barrier layer by fastening to the corrugated metal cover with anchors which have large washers. It is recommended to alternate board seams when two layer application is preferred. On top of that, waterproofing membrane (bituminous membrane, pvc, tpo, etc.) is applied.

Thickness (cm)	Width x Length (cm)	Package (m <sup>2</sup> )
3	60 x 120	5,76
4	60 x 120	4,32
5	60 x 120	3,60
6	60 x 120	2,88
8	60 x 120	2,16
10	60 x 120	1,44
12	60 x 120	1,44

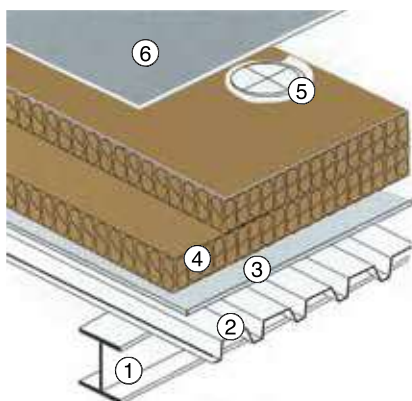

- Structural System ①
- İzocam Tekiz ②
- Corrugated Sheet
- Vapour Barrier ③
- Flat Roof Board ④
- Fastening Element ⑤
- Waterproofing ⑥

- Thermal insulation
- Fire safety
- Sound insulation
- Easy to apply
- Available in different sizes



# TECHNICAL DATA SHEET

## Izocam Flat Roof Board

	Symbol	Unit	Description							Tolerance	Standart
Material	-	-	Stonewool							-	TS EN 13162
Density	$\rho$	kg/m <sup>3</sup>	150							+/-10%	-
Width	b	mm	600							+/-1,5%	TS EN 822
Length	l		1200							+/-2%	TS EN 822
Facing	-	-	Unfaced							-	-
Thickness (Unfaced)	d	mm	30	40	50	60	80	100	120	T3(**)	TS EN 823
Reaction to Fire	-	-	A1							-	TS EN 13501-1
Declared Thermal Conductivity (10 °C)	ld	W/mK	0,040								TS EN 12667/12939
Thermal Resistance	R <sub>d</sub>	m <sup>2</sup> K/W	0,75	1,00	1,25	1,50	2,00	2,50	3,00	-	TS EN 13162
Water Vapor Diffusion Resistance (*)	m	-	1							-	TS EN 12086
Compressive Strength	s <sub>10</sub>	kPa	25	40	50	50	70	80	90	-	TS EN 826
Squareness	S <sub>b</sub>	mm/m	max.5							-	TS EN 824
Flatness	S <sub>max</sub>	mm	max.6							-	TS EN 825
Short Term Water Absorption with Partial Immersion	W <sub>p</sub>	kg/m <sup>2</sup>	max.1							-	TS EN ISO 29767
Long Term Water Absorption with Partial Immersion	W <sub>lp</sub>	kg/m <sup>2</sup>	max.3							-	TS EN ISO 16535
Packaging Material	-	-	PE Film							-	-
Other Information	Alufoil facings are also available.										

(\*\*) T3: -3% or -3mm ; +10% or +10mm. The biggest value is choosed at minus tolerance, The smallest value is choosed at + tolerance.

(\*) Literature value.

### Safety Reminders for Loading, Unloading, Shipping and Storing

- These operations should be done indoors if the weather is rainy.
- Loading and unloading should be done by (at least) two people.
- Products should be wrapped by a waterproof cover even if the shipping distance is short.
- Products should not be superposed with pallets.
- Products should not be put into upright position.
- Products should not be stepped on and should not be used as steps.
- Products should not be pulled by their package.
- Products should be in packages (10 each) and maximum 6 packages can be superposed.
- Before binding, hard cardboards (minimum 20 x 50 cm) should be put on the corners of packages to protect against possible damages by ropes.
- Storage area should be protected against any wet threats such as rain, float, etc. Indoor spaces should be preferred.
- The packages should be put on the floor with extra care so the corners of the product especially is not damaged by a hit.

Izocam is not responsible for any problem because of misprinting. Izocam, the manufacturer, reserves the right to alter product specifications without prior notice. Izocam also manufactures special products upon request. For your requirements, you are requested to contact our Export Department.

